

SPARE PARTS CATALOGUE

TRENS a.s.

SN40A

SN45A

SN50A

SN40B

SN45B

SN50B

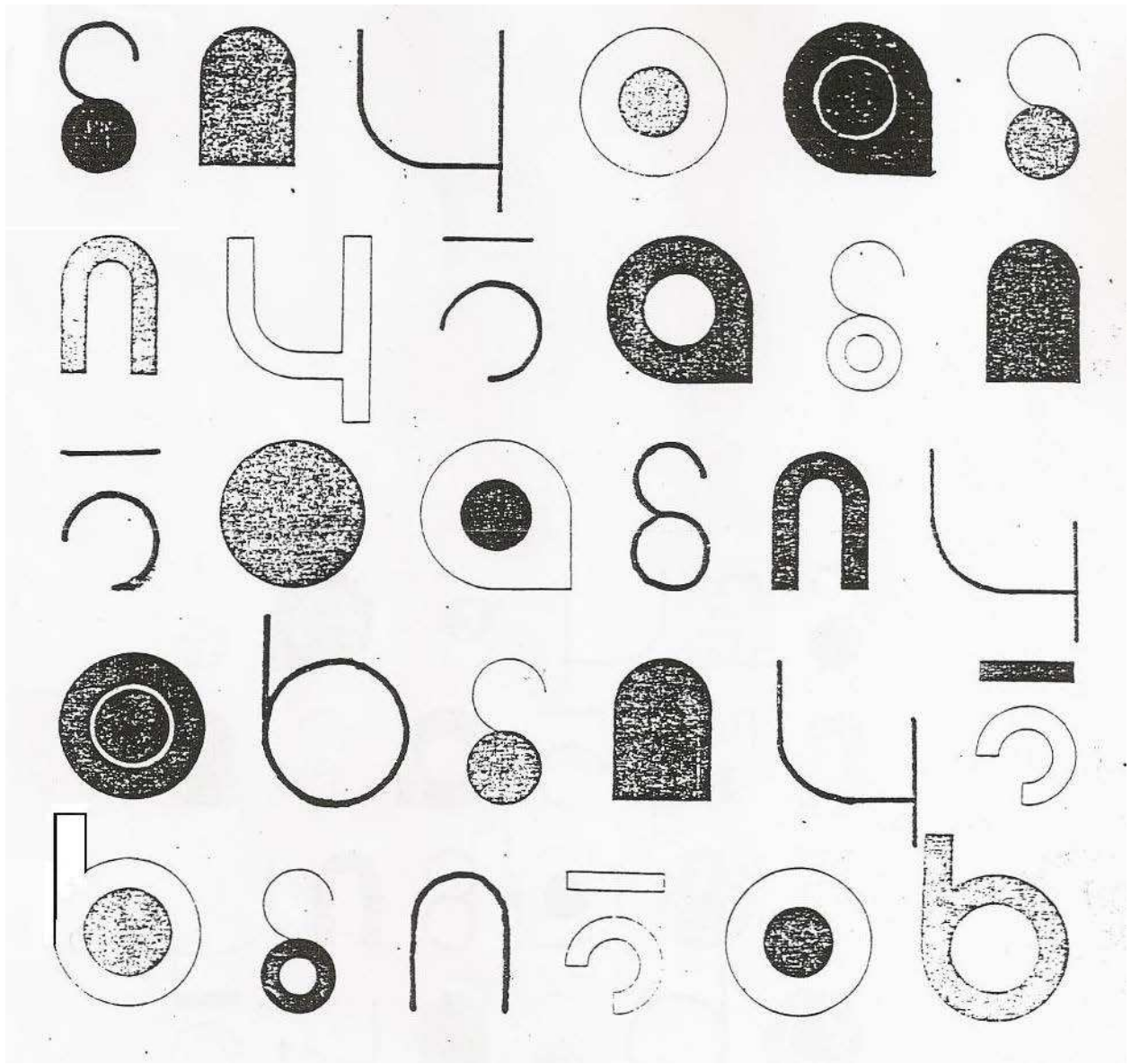

SN 40 A 45 A 50 A SN 40 B 45 B 50 B
CATALOUGE OF SPARE PARTS

The present catalogue includes illustrations of all machine parts and specification of parts that are delivered by the manufacturing works as replacement parts. The replacement parts available for delivery have the respective position numbers.

The components shown in the illustrations which have no position number or mark and which are not included in the specification of replacement parts are mostly components obtained from sub-suppliers or various packings, plugs, covers, spacing rings etc. such components are not stocked and delivered by the manufacturing works.

The components referred to in the catalogue without any item number are not shown in the illustrations.

Components which have no type designation are suitable for both "A" and "B" design versions

The completeness of the break-down of the individual assemblies of the machine into individual components gives an idea of the construction of the machine.

In addition to the customary terms of a valid order for replacement parts, it is necessary to add to each order:

1. Type designation, production number of machine, turning length and assembly of machine for which the ordered replacement parts are required.
2. Reference to item number and drawing number stamped on respective component.
3. Number of pieces required.

Example: We order hereby the following replacement parts for the SN40A centre lathe, Prod. No. - . Turning length of 1,500mm.

Machine assembly: headstock

2 pieces connecting ring

17-161391

3 piece bi-partite ring

14-S4 VL 2480

Deliveries of all sub-contracted parts (bearings and other above mentioned parts) should be ensured direct from their manufacturers, or through the medium of their sales organizations. The manufacturing works do not stock and deliver such parts.

Due to continued improvements of the design of the machine, small design changes are continuously being effected. Such changes cannot be incorporated in the present catalogue.

BED ASSEMBLY

801000

1	2	3	4	5	6
No	Pos No	Drawing No	Denomination	No of Pcs	Weight in Kg per Pc
1	801006	2 04 09 1443	End Bearing	1	6.20
2	801011	5 04 30 1724	Plug	2	0.08
3	801039	4 04 34 3413	Gib Strip underneath motor	2	3.10
4	801043	4 50 34 557	Gib Strip	2	2.60
5	801041	5 50 41 345	Screw	4	0.07
6a	801032	4 50 09 331	Pulley	1	4.20 For 50 HZ
6b	801034	4 50 09 332	Pulley	1	3.50 For 60 HZ
7	822006	43 04 54 525	Left- Hand guide strip	1	1.95
8	822007	3 04 54 526	Right-Hand guide strip	1	1.55

Table applicable to Turning Length of 1000mm

1	2	3	4	5	6
No	Pos No	Drawing No	Denomination	No of Pcs	Weight in Kg per Pc
9	801215	4 04 19 233	Rack	1	00.86 SN 40 A-50 A
10	801122	3 04 19 342	Rack	1	04.30
11	801121	3 04 19 340	Rack	1	01.80
13a	801130	3 04 39 287	Lead Screw	1	13.80
14a	801126	3 04 11 2617	Feed Rod	1	09.00
15a	801128	3 04 11 3359	Disengaging Rod	1	11.10

Table applicable to Turning Length of 1500mm

1	2	3	4	5	6
NO	Pos No	Drawing No	Denomination	No of Pcs	Weight in Kg per Pcs
9	801215	4 04 19 233	Rack	1	00.86 SN 40 A-50 A
10	801122	3 04 19 342	Rack	2	04.30
13b	801153	3 04 39 284	Lead Screw	1	18.10
14b	801149	3 04 11 2483	Feed Rod	1	10.80
15b	801151	3 04 11 3360	Disengaging Rod	1	13.60

Table applicable to Turning Length of 2 000mm

1	2	3	4	5	6
No	Pos No	Drawing No	Denomination	No of Pcs	Weight in Kg per Pcs
9	801215	4 04 19 233	Rack	1	00.86 SN40 A-50 A
10	801122	3 04 19 342	Rack	2	04.30
12	801173	3 04 19 341	Rack	1	02.50
13c	801180	3 04 39 288	Lead Screw	1	21.90
14c	801177	3 04 11 2618	Feed Rod	1	13.18
15c	801178	3 04 11 3361	Disengaging Rod	1	16.00



13a 13b 13c



14a 14b 14c



15a 15b 15c

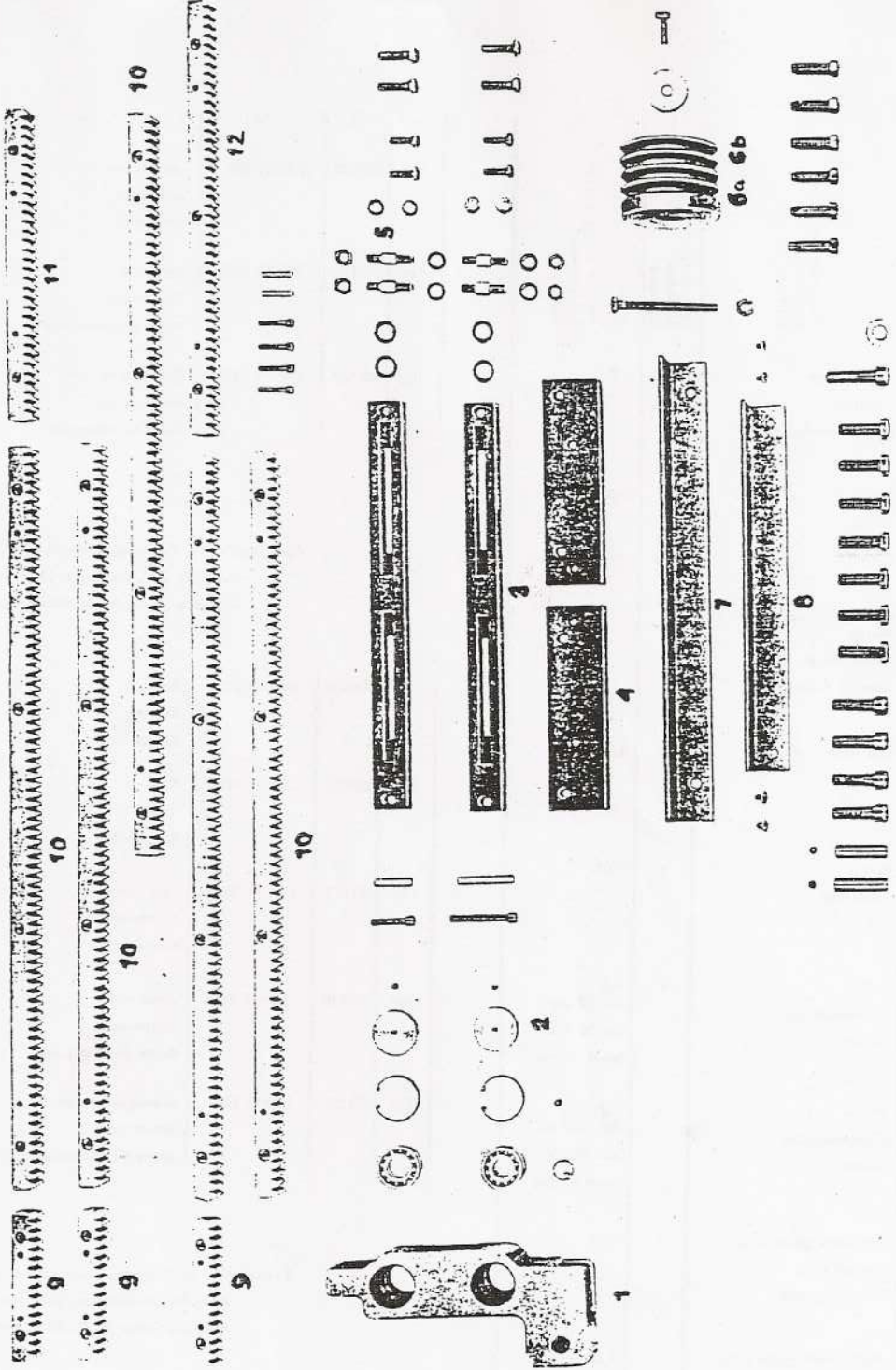

**HEADSTOCK
ASSEMBLY
802000**

1	2	3	4	5	6
No	Pos No	Drawing No	Denomination	No of Pcs	Weight in Kg per pcs
0	802000	1 04 70 792	Complete Headstock	1	135.00 SN 40 A
0	802000	1 04 70 792	Complete Headstock	1	138.00 SN 45 A
0	802000	1 04 70 792	Complete Headstock	1	143.00 SN 50 A
1a	802103	S1 VK-2458	Spindle	1	14.80 SN 40 A SN 50 A
2	802120	CSN 20 1012	Bayonet Washer 180	1	00.30
3	802119	CSN 20 1007	Driving Block 19	1	00.07
4	802121	CSN 20 1013	Bayonet Washer M 8x 15	1	00.04
5	802003	S3 VK-2460	Front Cover	1	05.30
6	802109	S4 VK-2461	Bi Partite Ring	1	00.32 Thickness To Be Modified To Provide A Good Fit.
7	802-78	CSN 02-4700	Roller Bearing NN 3016K/ ZP 52	1	01.48 With Radial Clearance Of 0.04-0.06 mm
8	802013	4 04 26 2441	Spacing Bush	1	01.85
9	802027	S4 VK-2396	Nut	2	00.62
10	802026	4 04 39 326	Nut	2	00.54
11	802015	4 50 26 553	Spacing Bush	1	02.80
12	802075		Bearing 7217/ PS-T	1	01.87
13	802074		Bearing 7215/ PS-T	1	01.23
14	802014	S4 VK-2480	Bi-Partite Ring	1	00.20
15	802004	3 04 09 0949	Sleeve	1	03.43
16	802011	4 01 25 2437	Distance Ring	1	00.65 Thickness To Be Modified To Provide A Good Fit.
17	802007	4 04 16 1391	Connecting Ring	1	01.20
18	802006	4 04 09 718	Cover	1	01.50
19	802018	4 04 34 1892	Clamp	1	01.70
20	802032	5 04 56 1041	Pipe	1	00.09
21	802033	5 04 56 1040	Pipe	1	00.07
22	892091	S4 VK-2543	Regulating Screw	1	00.12
23	802041	3 04 60 1590/ 1	Covering Plate	1	00.18
24aa	802156	1 04 03 656	Casing of Headstock	1	69.00 SN 40 A
24ba	802181	1 04 03 663	Casing of Headstock	1	76.00 SN 45 A
24ca	802214	1 04 03 660	Casing of Headstock	1	93.00 SN 50 A
0	0302000	1 50 70 352	Complete Headstock	1	132.00 SN 40 B
0	0302000	1 50 70 352	Complete Headstock	1	135.00 SN 45 B
0	0302000	1 50 70 352	Complete Headstock	1	140.00 SN 50 B
1b	0802105	1 50 10 0071	Spindle	1	12.30 SN 40 B 50 B SN
24ab	0802157	1 50 03 0285	Casing of Headstock	1	70.00 SN 40 B
24bb	0802185	1 50 03 0286	Casing of Headstock	1	77.00 SN 45 B
24cb	0802218	1 50 03 0287	Casing of Headstock	1	84.00 SN 50 B
25	0802916	4 50 26 0708	Connecting Ring	1	00.10 SN 40 B SN 50 B

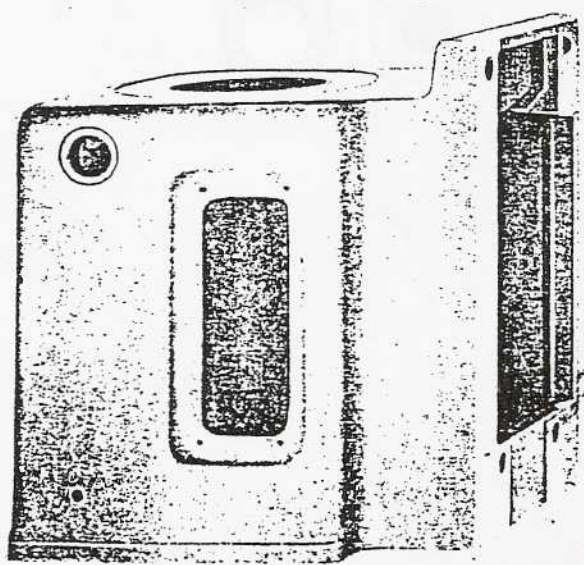
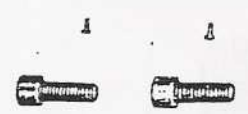
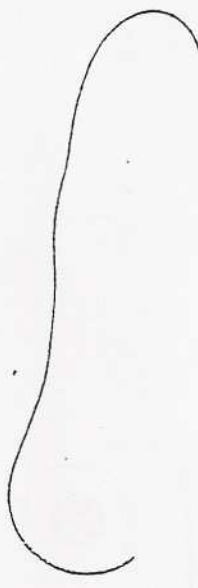
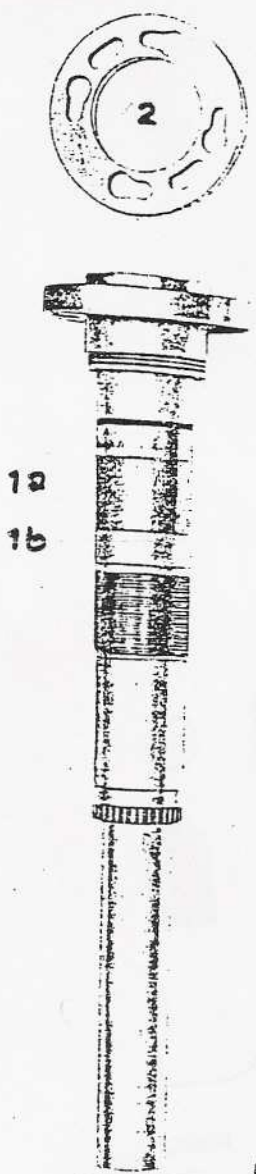

- 24a
- 24b
- 24c
- 24d
- 24e
- 24f

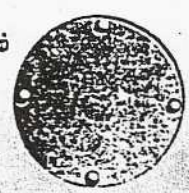
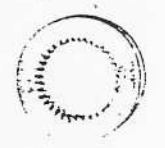
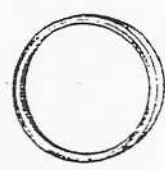
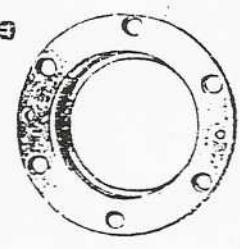
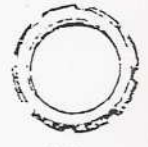
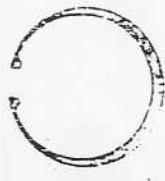
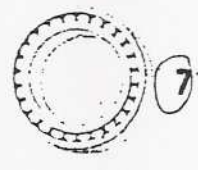
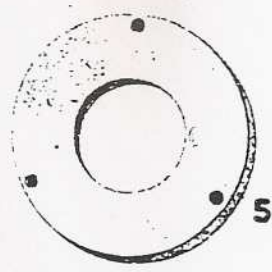
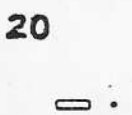
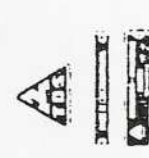

- 10
- 9
- 11
- 12
- 13
- 14
- 15
- 16
- 17
- 18

**SPEED GEARBOX
ASSEMBLY
803000**

1	2	3	4	5	6
No	Pos No	Drawing No	Denomination	No of Pcs	Weight in Kg per pcs
0	803000	1 04 70 1007	Complete Speed Gearbox	1	170.00 SN 40 A
0	803000	1 04 70 1007	Complete Speed Gearbox	1	172.00 SN 45 A
0	803000	1 04 70 1007	Complete Speed Gearbox	1	174.00 SN 50 A
1	803022	4 04 06 1116	Cover	1	0.49
2	803057	4 04 16 1040	Gear Wheel	1	0.10 To be Replaced
2a	803056	4 04 16 1039	Gear Wheel	1	0.10 At One Time
3	803114	5 04 23 1036	Sleeve	2	0.03
4	803003	2 04 03 899	Body of Pump	1	2.80
5	803076	3 04 16 1712	Driver	1	1.16
6	803139	5 04 26 2498	Distance Ring	1+ 1	0.012
7	803140	5 04 26 2502	Support Ring	2	0.03
8	803217	4 04 52 516	External Friction Disc	14	0.03
9	803221	4 04 52 517	Internal Friction Disc	16	0.03
10	803214	5 04 52 761	Lever	24	0.015
11	803185	4 04 39 282	Nut	2	0.36
12	803104	4 04 21 619	Sleeve	1	0.51
13	803036	2 04 11 2463	Shaft	1	6.25
14	803143	5 04 26 2997	Ring	1	0.11
15	803079	3 04 16 1723	Driver	1	0.42
16	803132	5 04 26 2490	Ring	1	0.25
17	803018	5 04 06 938	Cover	1	3.18
18	803131	5 04 26 2489	Ring	1	0.083
19	803032	3 04 09 964	Pulley	1	4.95
20	803174	4 04 34 2515	Lever	1	0.18
21	803048	4 04 11 2477	Rod	1	0.10
22	803121	4 04 24 906	Bush	1	0.17
23	803201	5 04 43 802	Washer	1	0.035
24	803107	4 04 21 622	Cover	1	0.20
25	803012	4 05 05 859	Lever	1	0.17
26	803049	3 04 11 2480	Rod	1	1.25
27	803148	5 04 30 1561	Lever	1	0.08
28	803155	5 04 30 1715	Hub	1	0.36
29a	803495	3 04 11 2459	Rod	1	0.83 SN 40 A
29b	803520	3 04 11 2460	Rod	1	0.90 SN 45 A
29c	803545	3 04 11 2461	Rod	1	1.05 SN 50 A
30	803010	3 04 05 856	Yoke	1	0.87
31	803180	5 04 25 649	Block	2	0.03
32	803040	4 04 11 2468	Rod	1	1.03
33	803042	4 04 11 2470	Rod	1	0.99
34	803071	4 04 16 1441	Gear Wheel	1	0.09
35	803181	5 04 35 650	Block	1	0.03
36	803136	4 04 26 2495	Hub	1	0.53
37	803011	3 04 05 858	Shifter	1	1.25
38	803026	3 04 08 029	Hollow Shaft	1	1.81
39	803167	4 04 30 2346	Hub	1	0.42
40	803146	5 04 30 1602	Lever	1	0.204
41a	803489	4 04 05 847	Bush	1	0.767 SN 40 A
41b	803514	4 04 05 848	Bush	1	0.85 SN 45 A
41c	803539	4 04 05 849	Bush	1	1.10 SN 50 A
42	803009	3 04 05 855	Lever	1	0.752
43	803052	5 04 11 2027	Pin	1	0.02
44	803051	5 04 11 2026	Pin	1	0.06
45	803274	CSN 02 3680	10 mm Dia. Ball	5	0.02
46	803013	3 04 05 991	Shifter	1	0.60
47	803225	3 04 54 524	Pull Rod	1	1.2

1	2	3	4	5	6
No	Pos No	Drawing No	Denomination	No of Pcs	Weight in Kg per pcs
48	803202	5 04 43 803	Washer	1	0.035
49	803043	4 04 11 2471	Rod	1	0.58
50	803041	4 04 11 2469	Rod	1	0.57
51	803054	5 04 11 3322	Pin	1	0.12
52	803173	4 04 34 1935	Lever	1	0.152
53	803179	5 04 34 1794	Block	1	0.03
54	803008	3 04 853	Shifter	1	0.84
55	803090	3 04 17 864	Gear Wheel 48/ 3.75	1	4.58
56a	803072	2 04 16 1442	Bush with Teeth	1	5.24 SN40 A SN 50A
57	803126	4 04 26 2483	Oil Ring	1	0.14
58	803127	4 04 26 2484	Oil Ring	1	0.35
59	803017	3 04 06 937	Cover	1	1.30
60	803616	S 2 VK-2465	Cover Assembly	1	1.86
61	803152	4 04 30 1712	Lid	1	0.29
62	803058	3 04 16 1418	Gear Wheel 49/ 2.75	1	1.55
63	893064	3 04 16 1434	Ger Wheel 63/ 2.5	1	3.16
64	803089	3 04 17 863	Pinion 18/ 3.75	1	1.63
65	803035	3 04 11 3490	Shaft	1	2.40
66	803164	3 04 30 2340	Lid	1	0.25
67	803144	4 04 30 1426	Lid	1	0.17
68	803096	3 04 19 407	Shaft	1	3.05
69	803059	4 04 16 1419	Gear Wheel 28/ 2.75	1	0.70
70	803060	4 04 16 1420	Gear Wheel 36/ 2.5	1	0.40
71	803023	2 50 03 234	Bush	1	3.70 With 3 Fixing Holes
72	803128	5 04 25 2485	Distance Ring	1	0.035
73	803087	4 04 17 861	Gear Wheel 35/ 3	1	1.05
74	803088	4 04 17 862	Gear Wheel 25/ 3	1	0.56
75	803024	2 50 03 235	Cover	1	1.92 With 3 Fixing Holes
76	803125	5 04 26 3020	Washer	2	0.05
77	803078	4 04 16 1716	Gear Wheel 42/ 2.75	1	1.05
78	803077	4 04 16 1715	Gear Wheel 25/ 3	1	1.00
79	803095	3 04 19 406	Shaft	1	2.85
80	803150	3 04 30 1709	Lid	3	0.20
81	803073	4 04 16 1710	Gear Wheel 30/ 3	1	0.64
82	803076	4 04 16 1714	Gear Wheel 18/ 2.75	1	0.31
83	803098	3 04 19 394	Spline Shaft	1	0.81
84	803256	3 04 60 1873	Triple Gear Assembly	1	2.15
85	803149	4 04 30 1707	Lid	1	0.26
86	803158	4 04 30 1986	Lid	1	0.141
87	803099	3 04 19 395	Shaft	1	2.24
88	803108	3 04 21 1766	Driver	1	0.94
89	803220	4 04 52 518	External Friction Disc	6	0.03
90	803222	4 04 52 519	Internal Friction Disc	5	0.03
91	803129	4 04 26 2486	Driver	1	0.19
92	803207	5 04 43 1119	Pad	1	0.27
93	803005	2 04 03 853	Body Of Brake	1	1.55
94	803190	5 04 41 1448	Pin	1	0.04
95	803191	5 04 51 1149	Screw	1	0.03
96	803172	4 04 34 1934	Lever	1	0.13
97	803080	4 04 16 1727	Intermediate Gear Wheel	1	0.90
98	803050	4 04 11 2967	Shaft	1	1.90
99	803075	4 04 16 1713	Gear Wheel 32/ 2.85	1	0.62
100	803062	4 04 16 1423	Gear Wheel 27/ 2.75	1	0.30
101	803063	4 04 16 1424	Gear Wheel 22/ 2.75	1	0.30
102	803130	5 04 26 2487	Distance Ring	1	0.18

1	2	3	4	5	6
No	Pos No	Drawing No	Denomination	No of Pcs	Weight in Kg per pcs
103	803016	4 04 16 1422	Gear Wheel 36/ 2.75	1	0.55
104a	803500	2 04 53 3255	Cover	1	0.702 SN 40
104b	803525	2 04 53 3285	Cover	1	0.85 SN 45
104c	803550	2 05 53 3284	Cover	1	0.98 SN 50
105a	803499	4 04 53 3291	Cover	1	0.11 SN 40
105b	803524	4 04 53 3292	Cover	1	0.214 SN 45
105c	803549	4 04 53 3293	Cover	1	0.315 SN 50
106	803082	4 04 16 2018	Gear Wheel 41/ 2.5	1	1.18
107	803044	4 04 16 3508	Shaft	1	0.67
108	803154	5 04 30 1714	Lid	1	1.09
109a	803505	4 04 57 744	Instruction Plate	1	0.15 SN 40
109b	803530	4 04 57 745	Instruction Plate	1	0.15 SN 45
109c	803555	4 04 57 746	Instruction Plate	1	0.15 SN 50
110	803242	4 04 57 619	Instruction Plate	1	0.04
111	803241	4 04 57 441	Instruction Plate	1	0.04
112	803115	5 04 23 1075	Ring	2	0.035
113	803069	4 04 16 1439	Gear Wheel 20/ 2.5	1	0.39
114	803120	5 04 24 905	Bush	1	0.10
115	803037	4 04 11 2465	Shaft	1	0.53
116	903200	5 04 54 801	Washer	1	0.03
117	803038	4 04 11 2466	Shaft	1	0.55
118	803119	5 04 24 904	Bush	1	0.08
119	803068	4 04 16 1438	Gear Wheel 20/ 2.5	1	0.34
120	803067	4 04 16 1437	Gear Wheel 36/ 2.5	1	0.95
121	803097	3 04 19 312	Spline Shaft	1	1.05
122	803118	3 04 24 902	Bush	1	1.10
123	803092	4 04 16 1061	Change Gear Wheel 30/ 1.5	1	0.12
124	803019	3 04 06 939	Gear Quadrant	1	2.90
125	803015	S 4 VK-2162	Washer	1	0.10
126	803039	4 04 11 2032	Pin	1	0.35
127	803117	4 04 24 764	Bush	1	0.09
128	803252	4 04 60 967	Pad Unit	2	0.08
129	803195	5 04 42 279	Block	1	0.14
130	803135	5 04 26 2493	Distance Ring	1	0.10
131	803203	5 04 43 807	Pad	1	0.05
132	803020	3 04 06 940	Cover	1	2.30
133	803034	5 04 11 3506	Arresting Pin	1	0.02
134	803183	4 04 35 731	Block	1	0.11
135	803109	4 04 21 855	Segment	1	0.28
136	803006	4 04 05 850	Lever	1	0.30
137	803046	4 04 11 2474	Pin	1	0.02
138	803106	4 04 21 621	Shifting Block	1	0.05
139	803014	4 04 05 1218	Lever	1	0.29
140	803047	4 04 11 2475	Pin	1	0.26
141	803157	3 04 30 1723	Hub	1	1.13
142	803045	4 04 11 2473	Small Shaft	1	0.42
143	803142	S 4 VK-2301	Hub	1	0.36
144	803260		Filter HEFA Z 50	1	0.70
145	803246	4 04 58 762	Sealing	1	0.002
146	803031	3 04 09 1397	Bush	1	1.67
147	803247	4 04 58 1052	Sealing	1	0.002
148	803194	5 04 41 1898	Coupling	1	0.13
149	803021	3 04 06 941	Cover	1	6.10
150	803101	S 4 VK-2169	Dezerating Plug	1	0.10
151	803193	S 4 VK-2021	Screw	1	0.03

1	2	3	4	5	6
No	Pos No	Drawing No	Denomination	No of Pcs	Weight in Kg per pcs
152	803393	4 04 03 0658	Plug G ¼ "	1	0.03
153	803228	5 04 56 1395	Tube	1	0.123
154	803226	S 4 VK-1946	Tube	1	0.15
155	803229	4 04 56 1397	Tube	1	0.025
156	803227	3 04 56 1633	Tube	1	0.13
157	803230	4 04 56 1398	Tube	1	0.046
158	803175	4 04 34 2544	Cube	1	0.20
159	803004	1 04 03 878	Casing Of Gearbox	1	125.00
160	803484	S 4 VK-1675	Star Wheel 50	1	0.15
161a	803490	S 2 VK-2235	Cover	1	7.00 SN 40
161b	803515	S 2 VK-2242	Cover	1	7.50 SN 45
161c	803540	S 2 VK-2246	Cover	1	8.00 SN 50
162a	803510	4 04 16 1565	Change Gear Wheel 48/ 1.5	1	0.45 SN 40
162b	803637	4 04 16 1059	Change Gear Wheel 60/ 1.5	1	0.73 SN 45
162c	803560	4 04 16 1054	Change Gear Wheel 80/ 1.5	1	1.36 SN 50
163	803093	4 04 16 1056	Change Gear Wheel 120/ 1.5	1	3.10
164	803192	5 04 41 1719	Screw	1	0.40
165	803177	5 04 34 1928	Hinge	1	0.04
0	0803000	1 04 70 1007	Complete Speed Gearbox	1	171.00 SN 40 B
0	0803000	1 04 70 1007	Complete Speed Gearbox	1	173.00 SN 45 B
0	0803000	1 04 70 1007	Complete Speed Gearbox	1	175.00 SN 50 B
56B	0803080	2 50 16 450	Toothed Bushing	1	5.80 SN 40 B- SN 50 B

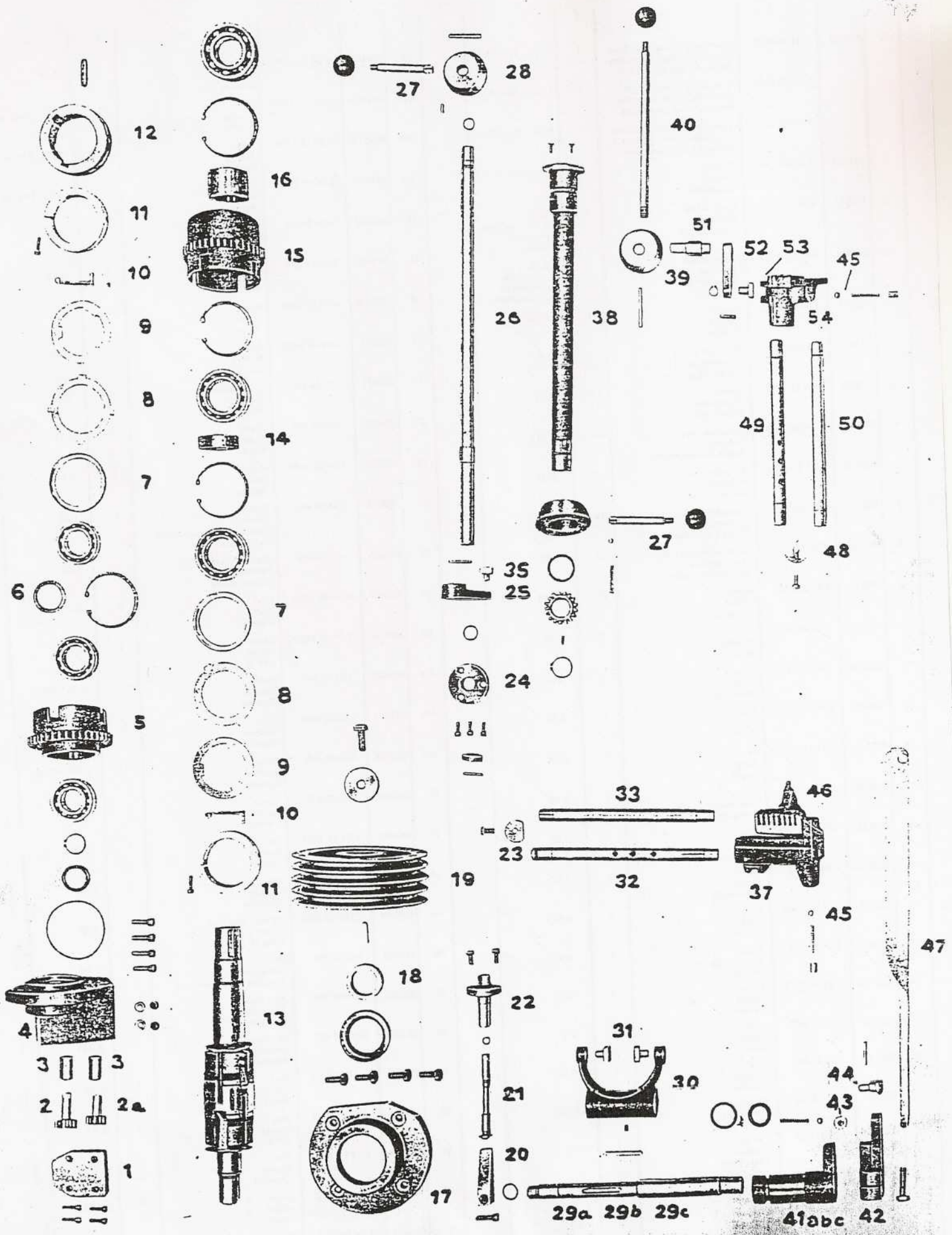

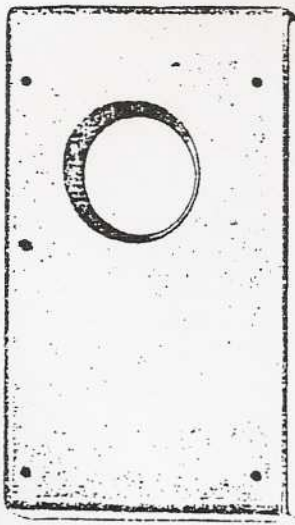

60

105a 105b 105c

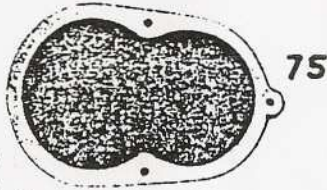
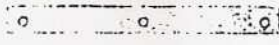

75

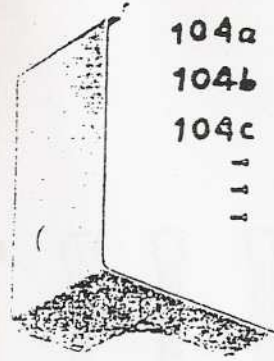

104a
104b
104c

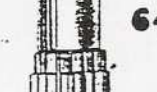
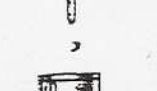
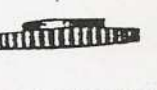
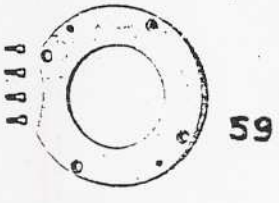
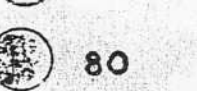
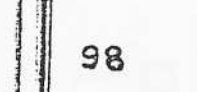
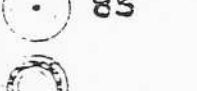
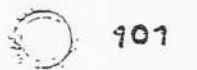
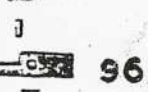
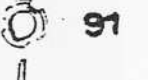
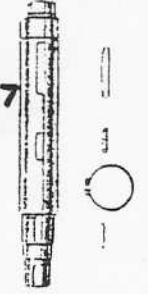
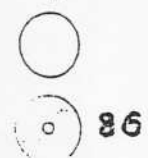
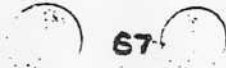
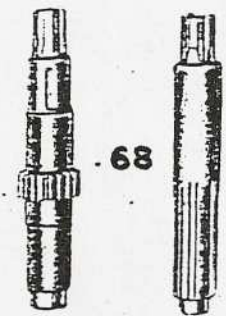
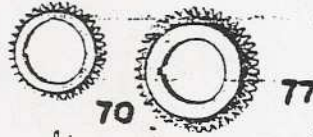
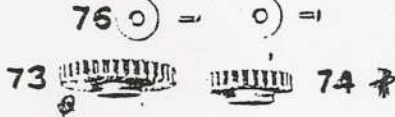

56a
56b

55

65

66

62

63

64

65

66

72

71

62

63

64

65

66

76

73

74

71

70

77

69

78

68

79

67

80

85

84

83

82

81

80

80

86

87

88

89

90

91

92

93

94

95

96

103

102

101

100

99

85

98

97

80

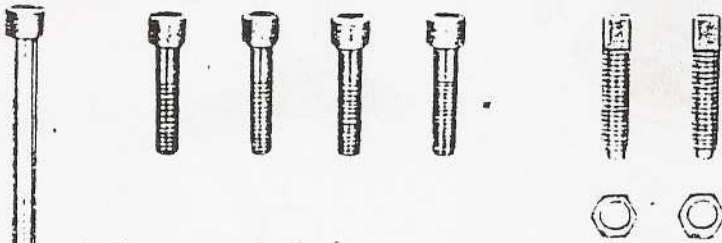

164

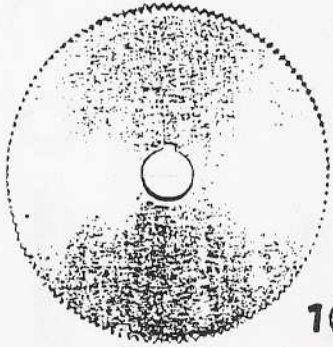

163

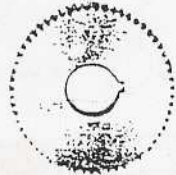

162a
162b
162c

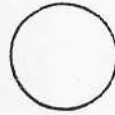

160



161a
161b
161c

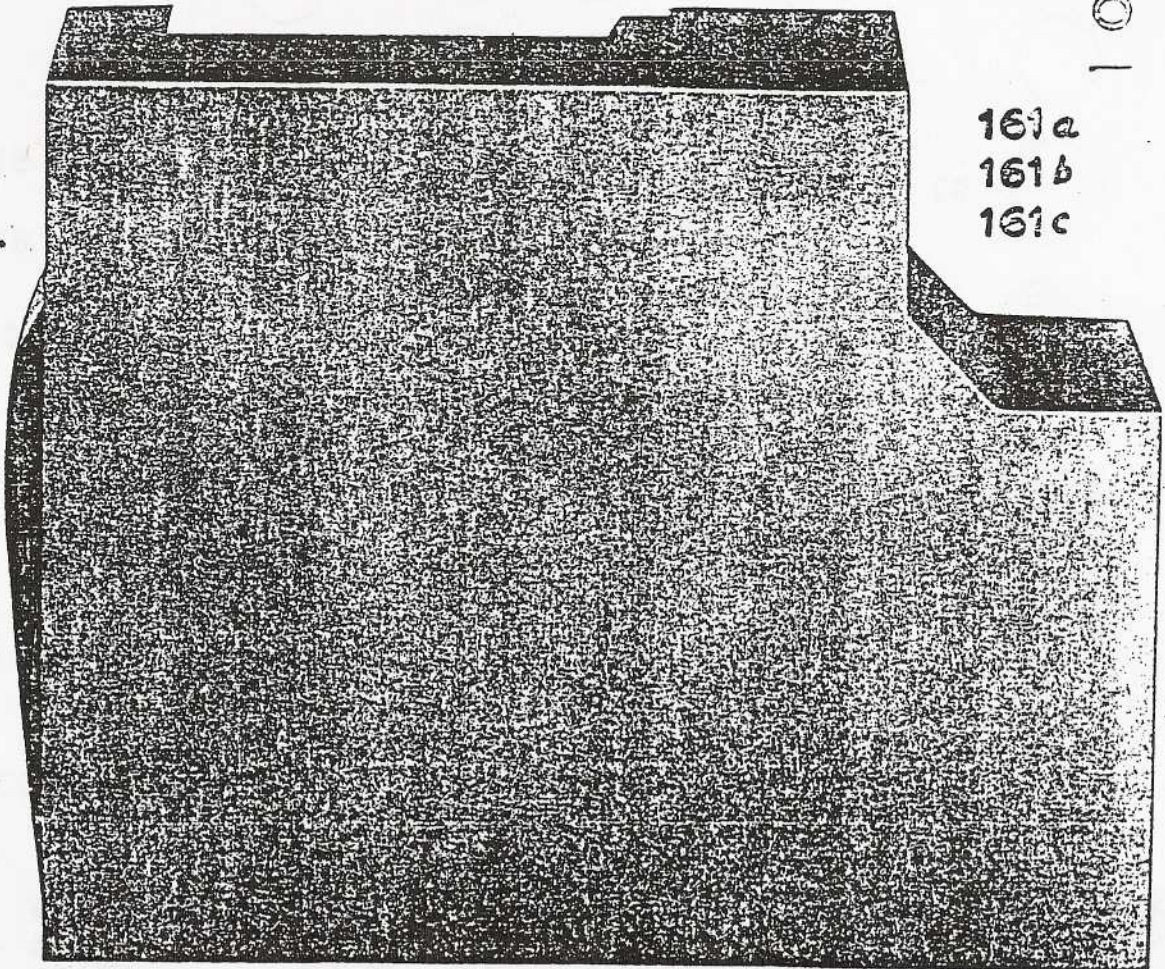

165



**Thread Cutting
Gearbox Assembly
80600**

1	2	3	4	5	6
No	Pos No	Drawing No	Denomination	No of Pcs	Weight in Kg per pcs
0	806000	1 04 70 735	Thread cutting Gearbox Assembly	1	87.00
1	806001	4 04 60 967	Washer Assembly	1	0.08
2	806101	4 04 26 1974	Insert	1	0.12
3	806106	4 04 26 3507	Insert	1	0.04
4	806088	3 04 21 864	Flange	1	1.40
5	806031	3 04 11 3467	Shaft	1	1.90
6	806051	4 04 17 764	Gear Wheel	1	0.08
7	806052	3 04 17 765	Duplex Gear Wheel	1	0.53
8	806059	3 04 17 772	Duplex Gear Wheel	1	1.63
9	806102	3 04 26 1975	Bush	1	0.80
10	806192	4 04 58 692	Sealing	1	0.001
11	806082	3 04 21 455	Flange	1	1.05
12	806098	5 04 26 1970	Ring	1	0.04
13	806096	5 04 26 3957	Ring	1	0.04
14	806264	4 04 42 687	Nut M 40 x 1.5	1	0.12
15	806191	4 04 58 691	Sealing	1	0.001
16	806462	3 04 30 2064	Lid	1	1.80
17	806151	5 04 46 1071	Pin	1	0.001
18	806100	4 04 26 1972	Ring	1	0.11
19	806157	5 04 51 760	Locking Piece	1	0.001
20A	806460	5 04 11 3021	Pin	1	0.038 SN 40ASN 50A
21	806067	4 04 18 787	Coupling	1	0.32
22	806057	3 04 17 770	Duplex Gear Wheel	1	0.56
23	806054	3 04 17 767	Duplex Gear Wheel	1	0.70
24	806075	3 04 19 230	Shaft	1	1.00
25	806043	4 04 16 1014	Gear Wheel	1	0.32
26	806074	3 04 19 229	Shaft	1	0.81
27	806040	4 04 16 1011	Gear Wheel	1	0.44
28	806053	3 04 17 766	Triple Gear Wheel	1	0.96
29	806083	3 04 21 456	Flange	1	0.90
30	806195	3 04 58 695	Sealing	1	0.002
31	806283	4 04 30 650	Plug M 14 x 1.5	1	0.02
32	806177	3 04 56 862	Lubrication Tube	1	0.10
33	806073	3 04 19 228	Shaft	1	0.70
34	806045	3 04 16 1016	Gear Wheel	1	0.70
35	806076	4 04 17 773	Gear Wheel	1	0.25
36	806110	5 04 30 1381	Cover	1	0.07
37	806104	5 04 26 2851	Ring	1	0.03 Thickness To Be Modified To Provide A Good Fit
38	806044	4 04 16 1015	Gear Wheel	1	0.33
39	806058	3 04 17 771	Duplex Gear Wheel	1	1.25
40	806056	3 04 17 769	Duplex Gear Wheel	1	1.05
41	806055	3 04 17 768	Duplex Gear Wheel	1	0.70
42	806103	5 04 26 1976	Ring	1	0.10
43	806090	4 04 24 749	Bush	1	0.16
44	806042	3 04 16 1013	Duplex Gear Wheel	1	0.45
45	806041	4 04 16 1012	Gear Wheel	1	0.70
46	806076	3 04 19 438	Shaft	1	2.40
47	806087	3 04 21 811	Flange	1	1.30
48	806061	4 04 17 774	Gear Wheel	1	0.50
49	806026	3 04 11 1969	Shaft	1	0.90
50	806193	4 04 58 693	Sealing	1	0.001
51	806080	3 50 21 134	Flange	1	1.50
52	806107	4 50 26 560	Cover	1	0.04

1	2	3	4	5	6
No	Pos No	Drawing No	Denomination	No of Pcs	Weight in Kg per pcs
53	806158	4 04 51 556	Spring	1	0.03
54	806421	CSN 13 7721	Connection Socket Js 6/ G	2	0.08
55	806125	S4 VK-2289	Washer	1	0.02
56	806036	5 04 15 462	Piston	1	0.033
57	806161	4 04 51 236	Spring	1	0.012
58	806007	4 04 03 896	Body Of Pump	1	0.60
59	806198	5 04 58 689	Sealing	1	0.0006
60	806147	5 04 43 1143	Plug	1	0.07
61	806179	S3 VK-2185	Casing Of Gearbox	1	0.07
62	806016	1 04 03 897	Casing Of Gearbox	1	31.00
63	806016	1 04 06 1134	Cover	1	12.50
64	806196	3 04 58 696	Sealing	1	1.01
65A	806532	2 04 57 749	Instruction Plate	1	0.30 SN 40
65B	806534	2 04 57 750	Instruction Plate	1	0.30 SN 45
65C	806536	2 04 57 751	Instruction Plate	1	0.30 SN 50
66	806185	5 04 57 419	Instruction Plate	1	0.017
67	806184	5 04 57 418	Instruction Plate	1	0.017
68	806086	3 04 21 794	Hub	1	1.10
69	806118	4 04 30 1391	Lever	1	0.25
70	806471	2 04 53 2469	Cover	1	1.17
71	806465	4 04 35 436	Fork	1	0.30
72	806025	5 04 11 1967	Small Fork	1	0.03
73	806134	4 04 35 629	Small Fork	1	0.11
74	806015	4 04 05 978	Lever	1	0.38
75	806085	5 04 22 542	Arresting Pin	3	0.01
76	806020	4 04 06 1120	Bearing	2	0.50
77	806030	4 04 11 2928	Shaft	2	0.14
78	806120	5 04 30 1561	Lever	3	0.08
79	806119	5 04 30 1560	Hub	2	0.40
80	806128	5 04 34 1702	Block	1	0.03
81	806014	4 04 05 977	Lever	1	0.40
82	806084	4 04 21 765	Cover	1	0.95
83	806166	4 04 52 420	Bearing	2	0.10
84	806028	4 04 11 1971	Rod Of Shifter	2	0.46
85	806100	5 03 30 337	Arresting Pin	2	0.03
86	806012	3 04 05 1000	Shifter	1	0.45
87	806011	3 04 05 999	Shifter	1	0.47
88	806013	4 04 05 700	Shifter	2	0.22
89	806029	4 04 11 1972	Rod	1	0.92
90	806027	4 04 11 1970	Guiding Block	1	0.02
91	806127	5 04 34 1400	Fork	1	0.12
92	806124	4 04 30 2526	Hub	1	0.40
93	806117	4 04 30 1386	Lever	1	0.12
94	806287	5 04 30 1379	Plug M 20 x 1.5	1	0.08
95	806513	4 50 60 175	Inter Locking Pawl	1	0.12
96	806512	4 04 60 1972	Inter Locking Pawl	1	0.12
20B	806460	5 50 11 894	Pin	1	0.45 SN 40 B SN 50 B

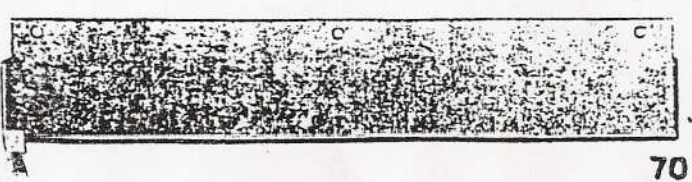
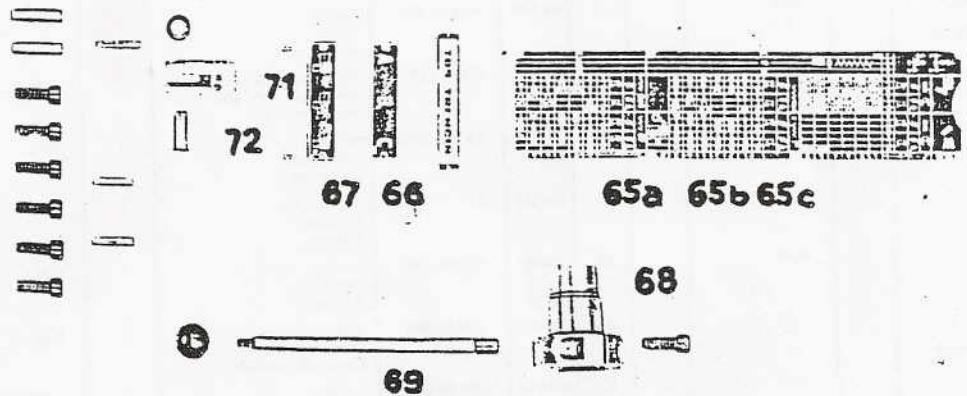
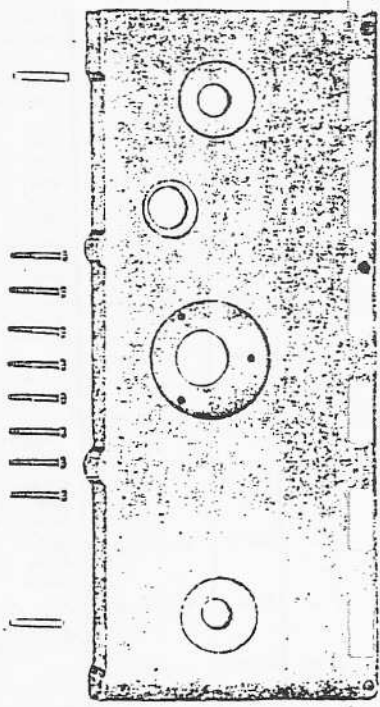
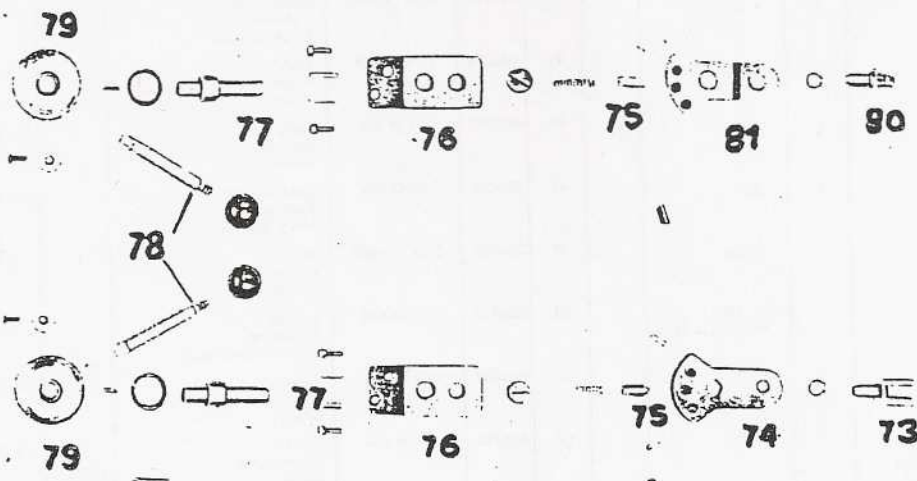
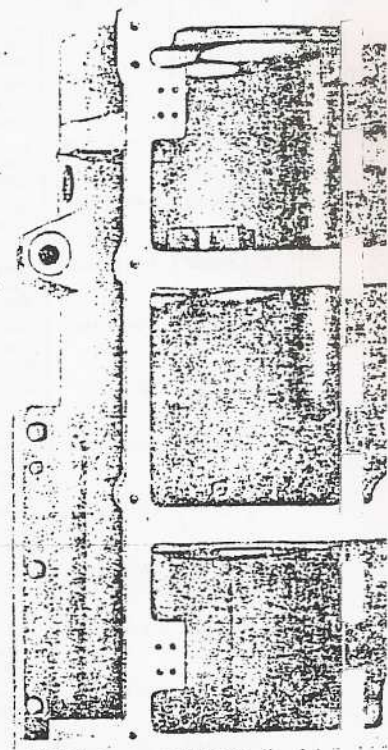
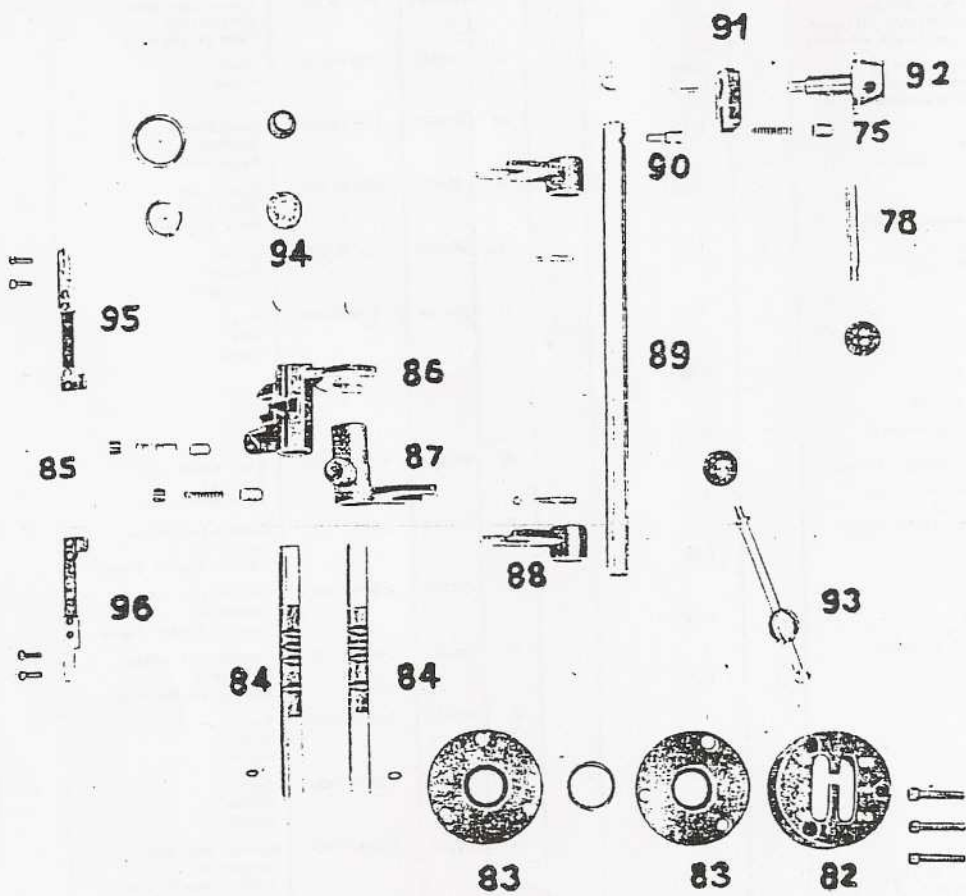

70

Apron-Assembly

1	2	3	4	5	6
No	Pos No	Drawing No	Denomination	No of Pcs	Weight in Kg per pcs
0	807000	1 04 70 757	Apron Assembly	1	74.00
1	807011	1 04 06 859	Cover	1	8.50
2	807091	3 04 34 1397	Strip Piece	1	0.05 To Be Provided With Final Fit
3	807098	5 04 41 1146	Screw	2	0.052
4	807266	CSN 02 5116.2	Handle With Pin	1	0.12
5	807162	2 04 31 055	Hand Wheel	1	4.90
6	807100	5 04 41 1151	Screw	1	0.20
7	807185	4 04 28 148	Vernier Scale in Metric	1	0.64
8	807083	5 04 30 1380	Cover	1	0.11
9	807016	4 04 09 739	Flange	1	0.99
10	807082	5 04 30 1378	Lever	1	0.29
11	807052	4 04 21 599	Cover	1	0.40
12	807149	S2 VK-2372	Tube	1	0.02
13	807099	5 04 1148	Screw	2	0.04
14	807113	5 04 51 558	Spring	2	0.015
15	807024	5 04 11 1964	Finger	2	0.05
16	807104	S3 VK-2390	Guard Cover	1	0.05
17	807119	4 04 54 668	Guard Cover	1	0.065
18	807122	4 04 50 213	Sealing	1	0.01
19	807157	4 04 23 925	Bushing	1	0.26
20	807095	5 04 34 3073	Packing Piece	2	0.02
21	807189	4 04 38 582	Nut	1	0.39
22	807123	4 50 50 088	Sealing	1	0.01
23	807116	4 04 53 1649	Guard Cover	1	0.17
24	807003	1 04 03 662	Casing Of Apron	1	38.00
25	807103	5 04 41 1520	Screw	1	0.06
26	807027	5 04 11 2611	Pin	1	0.10
27	807030	5 04 11 2971	Pin	1	0.016
28A	807014	4 04 08 017	Ring With Locking Piece	1	0.10 SN 40 A – SN 50 A
29A	807055	4 04 22 526	Joint	1	0.40 SN 40 A – SN 50 A
30	807063	3 04 24 744	Bushing	1	1.00
31	807017	3 04 09 510	Holder Of Nut	1	1.80
32	807066	4 04 24 965	Bushing	1	0.80
33	807096	4 04 38 465	Screw	1	0.73
34	807086	4 04 30 2455	Hub	1	0.85
35	807084	5 05 30 1561	Lever	1	0.08
36	807085	5 04 30 1602	Lever	1	0.20
37	807039	4 04 16 1006	Gear Wheel	1	1.40
38	807022	4 04 11 1960	Shaft VII	1	0.50
39	807069	5 04 26 1960	Ring	1	0.05
40	807035	3 50 16 394	Pinion VI	1	1.45
41	807062	4 04 24 742	Bush	1	0.20
42	807181	4 04 16 1002	Gear Wheel	1	1.93
43	807074	5 04 26 1966	Ring	1	0.17
44	807037	4 04 16 1000	Gear Wheel	1	1.00
45	807180	3 04 16 997	Pinion	1	0.86
46	807070	5 04 26 1961	Ring	1	0.11
47	807058	5 04 23 761	Bushing	2	0.10
48	807026	4 04 11 2305	Shaft	1	0.50
49	807043	4 04 16 1588	Intermediate Gear Wheel	1	0.50

1	2	3	4	5	6
No	Pos No	Drawing No	Denomination	No of Pcs	Weight in Kg per pcs
50	807064	4 04 24 746	Insert	1	0.12
51	807023	4 04 11 1961	Shaft	1	0.46
52	807124	3 04 60 1348	Complete Rear Shifter	1	0.82 For Longitudinal Feed
53	807125	3 04 60 1349	Complete Front Shifter	1	0.82 For Cross Feed
54	807068	5 04 26 1959	Ring	1	0.016
55	807045	4 04 16 1688	Gear Wheel	2	0.17
56	807025	5 04 11 1965	Pin	2	0.06
57	807028	5 04 11 2788	Shaft	1	0.51
58	807012	4 04 07 220	Lever Of Pump	1	0.063
59	807006	4 04 05 812	Front Holder	1	0.20
60	807006	4 04 05 812	Rear Holder	1	0.20
61	907075	5 04 26 1967	Ring	1	0.04
62	807077	5 04 26 2711	Ring	2	0.008
63	807107	5 04 46 1106	Pin	2	0.04
64	807021	4 04 11 1959	Shaft I V	1	0.50
65	807040	4 04 11 1007	Gear Wheel	2	0.50
66	807076	5 04 26 1068	Insert	1	0.063
67	807038	4 04 16 100	Gear Wheel	1	0.65
68	807041	4 04 16 1008	Gear Wheel	2	0.156
69	807036	4 04 16 999	Gear Wheel	4	0.153
70	807042	4 04 16 1009	Gear Wheel	2	0.20
71	807080	5 04 28 215	Indicator	1	0.001
72	807020	4 04 11 1958	Shaft III	1	0.73
73	807059	5 04 23 762	Bushing	1	0.09
74	807049	4 04 18 913	Worm Gear	1	0.60
75	807071	5 04 26 1962	Ring	1	0.184
76	807019	3 04 11 1957	Shaft II	1	1.05
77	807044	3 04 16 1604	Gear Wheel	1	0.65
78	807121	5 04 58 689	Sealing	1	0.006
79	807032	5 04 15 178	Piston	1	0.073
80	807002	4 04 03 439	Body Of Pump	1	0.65
81	807111	4 04 51 557	Spring	1	0.007
82	807110	4 04 51 556	Spring	1	0.0002
83	807072	5 04 26 1964	Ring	1	0.27
84	807048	4 04 18 909	Worm	1	0.742
29B	0807300	4 50 30 217	Lever Joint	1	0.38 SN 40 B 50 B
28B	0807304	4 50 26 492	Ring	1	0.18 SN 40 B 50 B
28B	0807301	54 VK-1572	Piston Of Lever	2	0.0005 SN 40 B 50 B
28B	0807302	54 51-0182	Spring Of Piston	2	0.01 SN 40 B 50 B

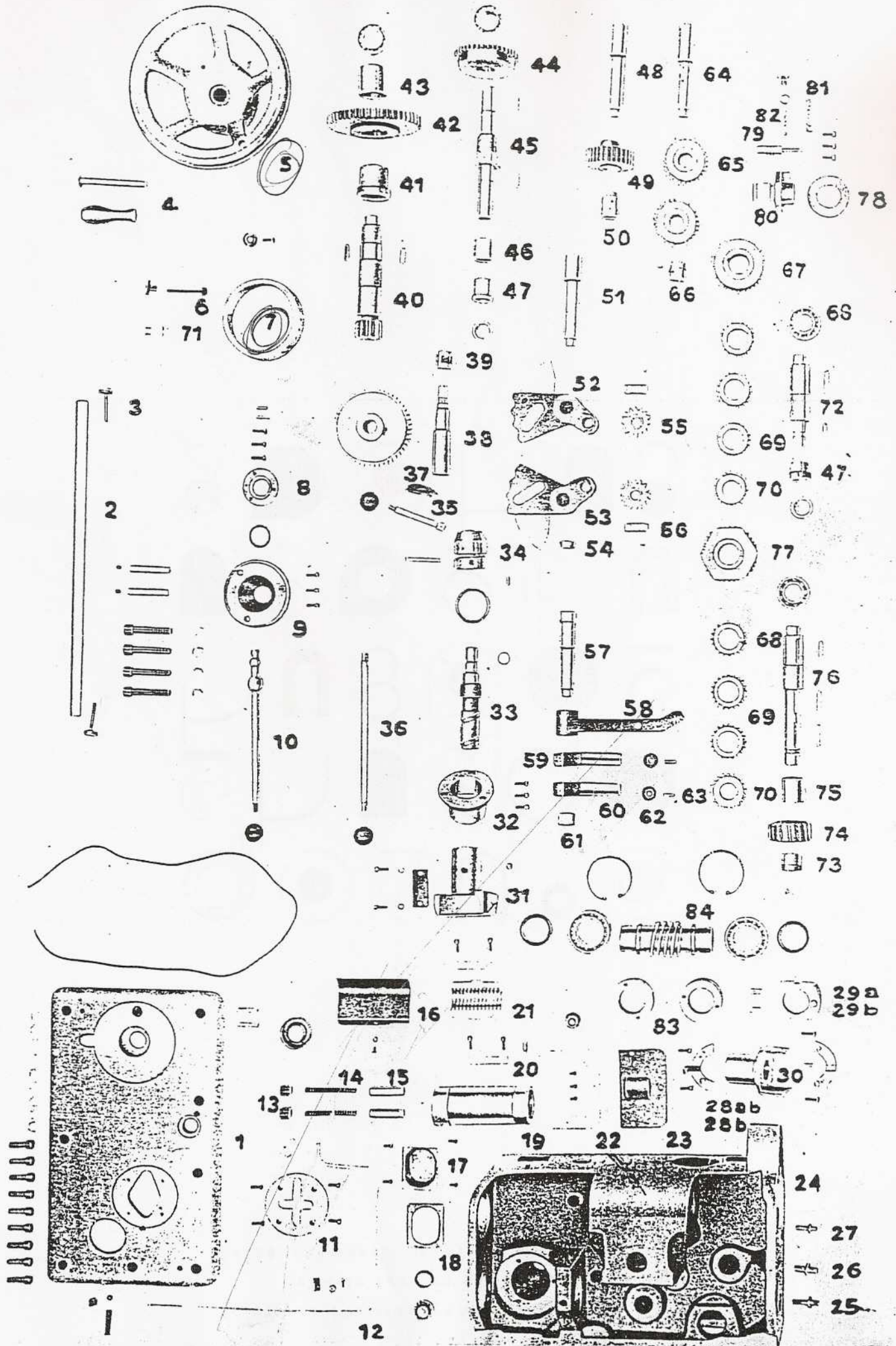

CARRAGE SLIDE AND ASSEMBLY

1	2	3	4	5	6
No	Pos No	Drawing No	Denomination	No Of Pcs	Weight In Kgs Per Pcs
1	804036	3 04 33 325	Strip Piece	1	1.75
2	804103	4 04 52 541	Guard Cover	1	0.12
3	804073	5 04 41 1474	Screw	4	0.05
4	804003	1 04 01 609	Cross Slide	1	40.00
5AA	804267	0 04 01 717	Saddle Of Carriage	1	38.00 SN 40- A 45 A
5BA	804320	1 04 01 718	Saddle Of Carriage	1	45.00 SN 50 A
6A	804049	4 04 34 2000	Packing Piece	1	0.02 Applicable To Non-Hardened Bed
6B	804386	4 50 34 399	Packing Pieces	1	0.02 Applicable To Hardened Bed Ways
7	804097	5 04 52 536	Wiper	2	0.001
8A	804098	5 04 52 537	Wiper	1	0.001
8B	804100	5 04 52 539	Wiper	2	0.001
9	804106	5 04 58 895	Felt Wiper	2	0.0006
10A	804046	4 04 34 1995	Packing Piece	1	0.72 For Non-Hardened Bed Ways SN 40 A-50 A
10B	804382	4 50 34 397	Packing Piece	1	0.72 For Hardened Bed Ways SN 40 A-50 A
11	804047	4 04 34 1997	Packing Piece	1	0.17
12	804-96	5 04 52 535	Wiper	1	0.001
13	804048	4 04 34 1999	Packing Piece	1	0.028
14A	804043	5 04 34 1989	Packing Piece	1	0.01 For Non Hardened Bed Ways SN 40 A-50 A
14B	804388	4 50 34 400	Packing Piece	1	0.01 For Hardened Bed Ways SN 40 A-50 A
15	804099	5 04 52 538	Wiper	2	0.001
16	804107	5 04 58 896	Wiper	2	0.001
17	804045	4 04 34 1994	Packing Piece	1	0.50 SN 40 A-50 A
18	804044	5 04 34 1990	Packing Piece	1	0.01
19	804077	5 04 41 1739	Screw	2	0.11
20	804032	5 04 34 3050	Strip Piece	1	0.30
21	804063	54 VK-2673	Hold Down Strip Piece	1	3.50
22	804054	54 VK-2674	Slide Strip Piece	1	0.80
23	804017	3 04 16 1910	Pinion	1	1.30
24	804003	3 04 09 1429	Bearing	1	2.14
25	804124	4 04 28 300	Vernier Scale In Metric	1	0.28
26	804009	4 04 09 944	Drum	1	0.80
27	804243	CSN 02 5116.2	Handle With Pin	1	0.10
28	804070	5 04 41 1470	Screw	2	0.015
29	804129	3 04 38 410	Screw	1	1.05
30A	804281	4 04 38 486	Nut	1	0.43 SN 40 A-45 A
30B	804338	4 04 38 488	Nut	1	0.72 SN 50 A
31	804060	5 04 11 3026	Pin	1	0.09
32	804023	4 04 24 919	Flange	1	0.33
33	804026	5 04 26 2561	Washer	2	0.02
34	804078	5 04 42 984	Nut	2	0.003
35	804018	4 04 21 652	Lid	1	0.34
36	804054	2 04 35 730	Four-Way Tool Block	1	6.20
37	804025	5 04 26 3036	Ring	1	0.052
38	801027	5 04 26 3031	Ring	1	0.072
39	801024	4 04 24 1034	Bushing	1	0.30
40	804057	4 04 38 402	Screw	1	0.29
41	804031	4 04 30 1751	Socket Spanner	1	0.58
42	804256	4 04 38 403	Bushing	1	0.55
43A	804269	2 04 01 603	Carriage Guide Ways	1	6.20 SN 40 A

1	2	3	4	5	6
No	Pos No	Drawing No	Denomination	No Of Pcs	Weight In Kgs Per Pcs
43B	804297	2 04 01 801	Carriage Guide Ways	1	7.00 SN 45 A-50 A
44	804059	2 04 06 964	Compound Saddle	1	10.00
45	804037	3 04 33 326	Strip Pieces	1	0.22 To Be Provided With Final Fit
46	804011	5 04 11 1979	Pin	1	0.35
47	804030	4 04 30 1750	Pawl	1	0.02
48	804084	5 04 51 681	Spring Of Arresting Equipment	1	0.018
49	804021	5 04 23 936	Bushing	1	0.045
50	804242	CSN 02 5116.2	Handle With Pin	1	0.08
51	804202	4 04 43 553	Washer	2	0.018
52	804016	4 04 09 1427	Hub	1	0.75
53	804112	4 04 28 200	Vernier Scale In Metric	1	0.20
54	804032	4 04 30 1754	Lid	1	0.22
55	804015	4 04 16 1454	Pinion	1	0.13
56	804127	4 04 38 408	Screw	1	0.30
57	804005	2 04 09 1481	Bearing	1	1.40
58	804079	5 04 42 985	Nut	2	0.03
59	804012	5 04 11 2514	Pin	1	0.025
60	804134	4 04 38 490	Nut	1	0.12
14A	030404 2	4 50 34 400	Packing Piece	1	0.02 SN 40 B - 50 B
5AB	083426 3	1 50 01 188	Carriage Slide	1	38.00 SN 40 B - 45 B
5BB	030432 1	1 50 01 189	Carriage Slide	1	42.00 SN 50 B

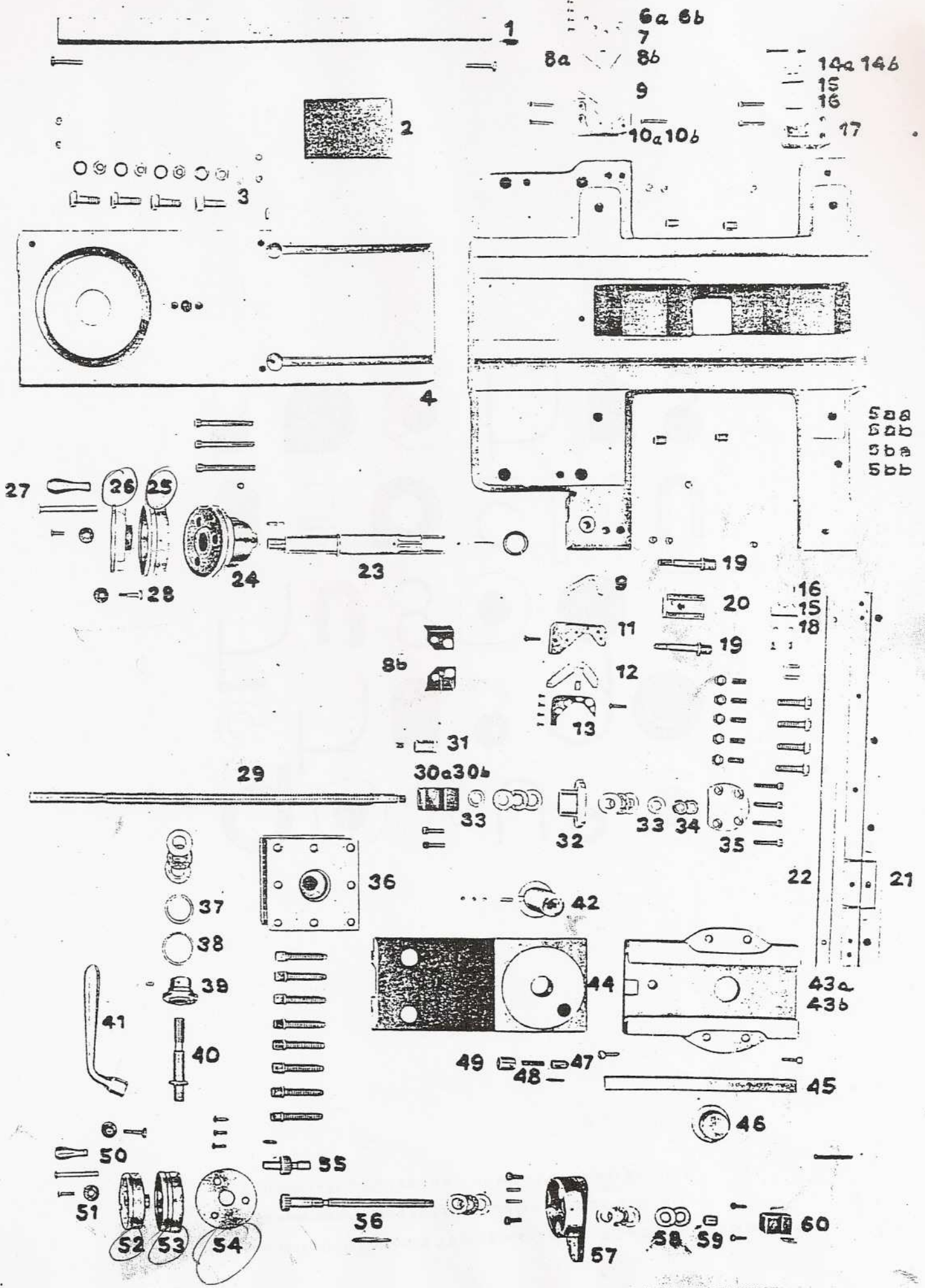

TAILSTOCK ASSEMBLY

1	2	3	4	5	6
No	Pos No	Drawing No	Denomination	No Of Pcs	Weight In Kgs Per Pcs
0	805300	1 50 70 244	Tailstock-Assembly	1	50.00 SN 40 To Be Provided With Final Fit
0	805300	1 50 70 244	Tailstock-Assembly	1	57.00 SN 45 To Be Provided With Final Fit
0	805300	1 50 70 244	Tailstock-Assembly	1	63.00 SN 50 To Be Provided With Final Fit
1	805308	2 04 10 266	Tailstock Barrel	1	7.60 Dia. To Be Stated With Accuracy
2	805320	4 04 38 384	Nut	1	
3	805302	1 50 03 194	Body Of Tailstock	1	30.00
4	805322	3 04 38 385	Screw	1	0.76
5	805310	4 04 24 389	Bearing	1	1.00
6	805314	2 04 21 067	Wheel	1	2.32
7	805324	CSN025116.2	Handle With Pin	1	0.10
8	805326	4 50 41 232	Nut	1	0.12
9	805331	4 50 43 084	Washer	1	0.02
10	805305	3 50 08 294	Clamp	1	2.76
11A	805358	4 50 41 418	Screw	1	0.76 SN 40
11B	805385	4 50 41 419	Screw	1	0.85 SN 45
11C	805412	4 50 41 420	Screw	1	0.98 SN 50
12	805315	3 50 12 008	Eccentric	1	0.80 To Be Ordered To One Time
13	805311	4 50 30 430	Lever	1	0.22 To Be Ordered To One Time
14	804304	3 50 05 219	Bearing	1	0.68
15	805325	4 04 41 2148	Screw	1	0.09
16	805316	4 04 34 3312	Strip Piece	1	0.45
17A	805353	2 05 01 130	Plate	1	16.00 SN 40
17B	805380	2 50 01 131	Plate	1	19.50 SN 45
17C	805407	2 05 01 132	Plate	1	23.00 SN 50
18	805330	4 50 43 075	Pad	4	0.10
19	805318	5 04 35 639	Block	1	0.04
20	805332	5 04 46 362	Pin	1	0.01
21	805313	4 50 30 325	Lever	1	0.06
22	805323	54 25 0525	Upper Jaw	1	0.27
23	805324	54 25 0526	Bottom Jaw	1	0.25

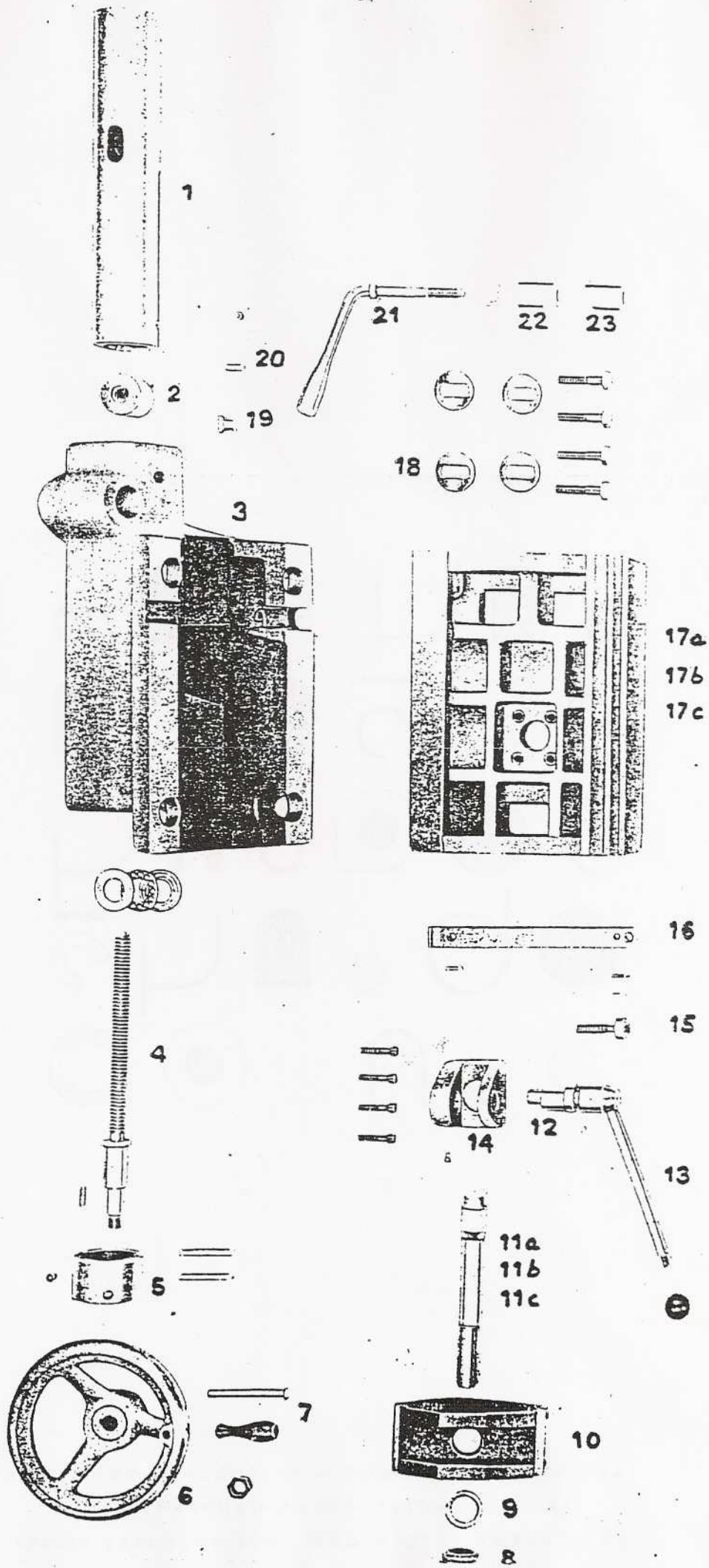

ELECTRICAL EQUIPMENT

1	2	3	4	5	6
No	Pos No	Drawing No	Denomination	No Of Pcs	Weight In Kgs Per Pcs
1	808560	Type 1104-34	Lamp	1	0.85
2	808095	Red	Push-Button Type 236 A 01	1	0.20
3	808094	Green	Push-Button With Signal Lamp Type 236- 010	1	0.20
4	808096	Black	Push-Button Type 236 B 10	1	0.20
5	808351	Jo-005	Transformer 220/ 24	1	2.10 SN 40 A - 50 A
6	808359	R 100-05 A	Thermal Relay	1	0.285
7	808117	Coil 220 V	Contacto VM-014	1	0.50
8	808360	R 100-10 A	Thermal Relay	1	0.285
9	808113		Contacto VO3C-009	1	1.150
10	808079		Switch VK-25	1	1.00
11	808169	ZM 4-PO	Socket	2	0.20
12	808179	Type S061-55	Socket	1	0.15 SN 40 A - 50 A
13	809020 5	JO-02	Transformer 220/ 24	1	4.10 SN 40 B - 50 B
14	089012 5	White	Signal Lamp 236 E	1	0.07 SN 40 B - 50 B

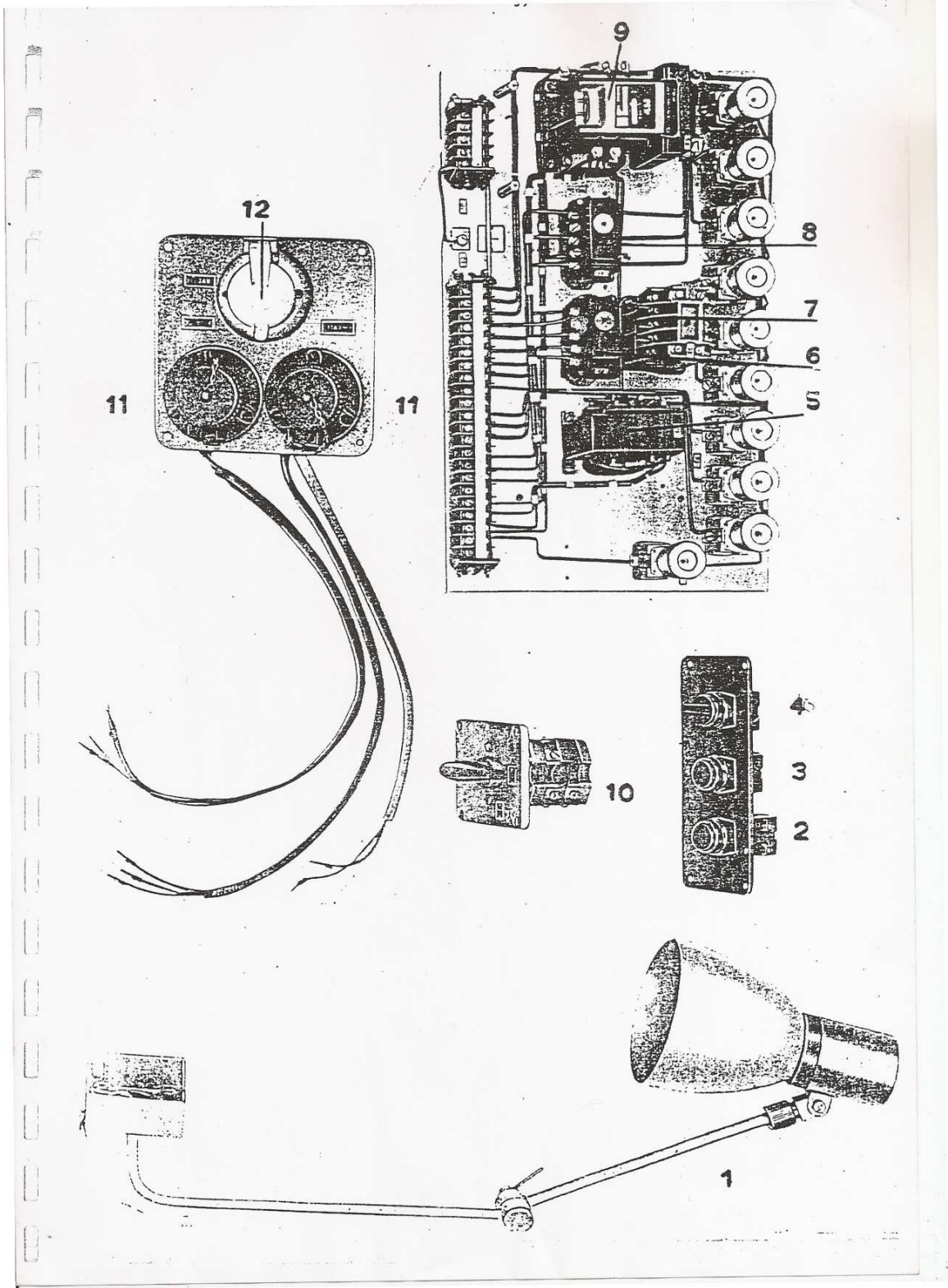

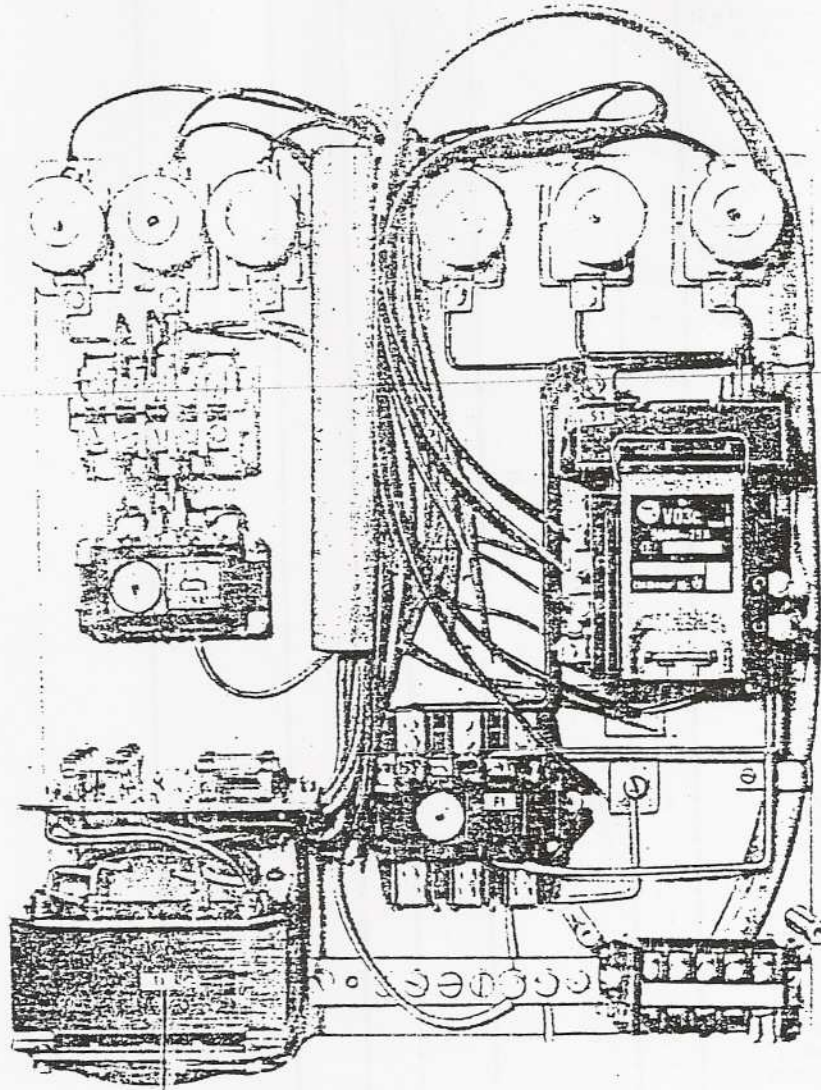

13

